

"20255 Lapeer Twp. Offices" printed on Mon 30-Nov-2020 at 10:59am by burmann using gUtilities v.4.1. Drawings and architectural design copyright © 2020 Burmann Associates Architects. All rights reserved.

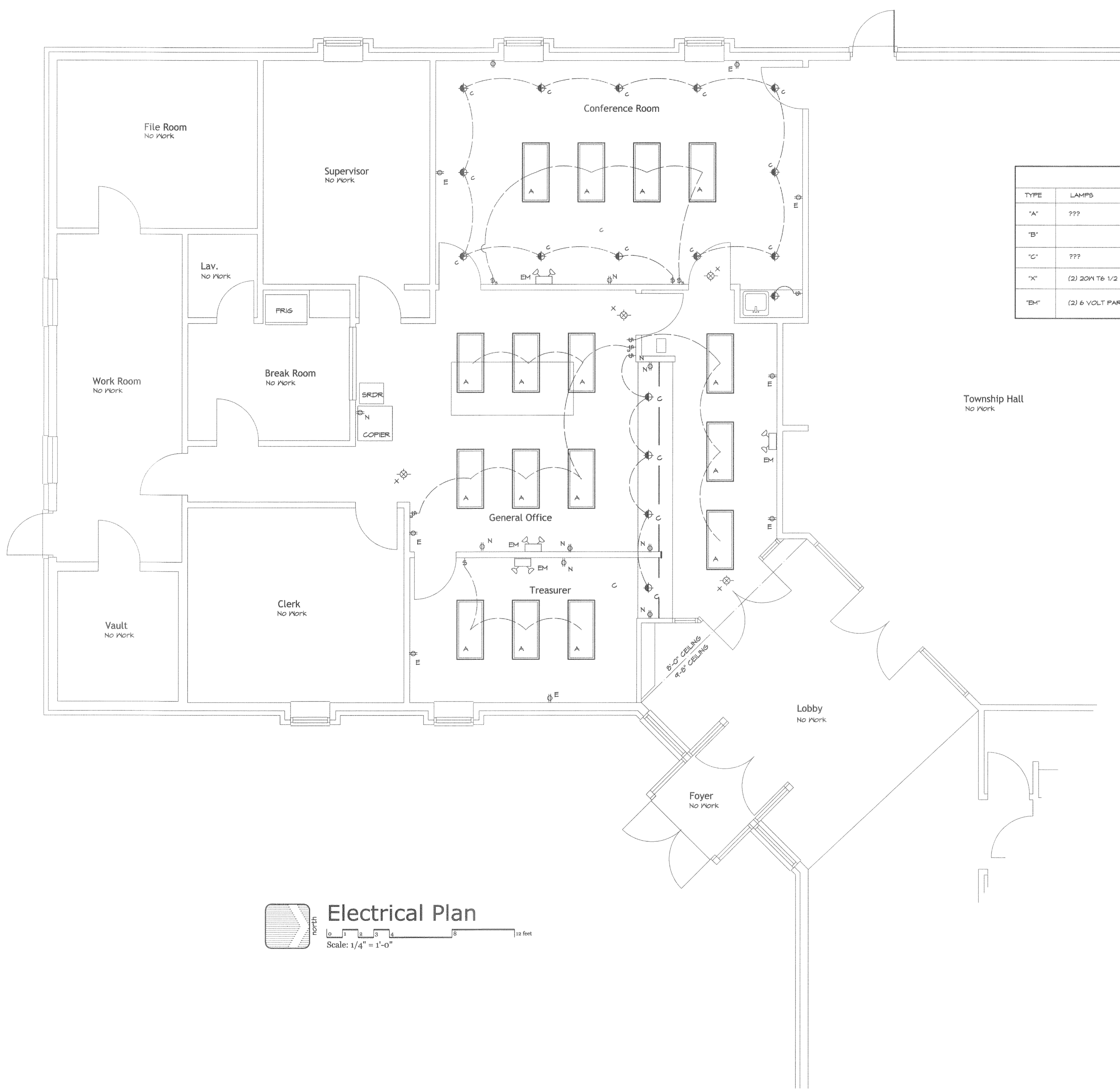
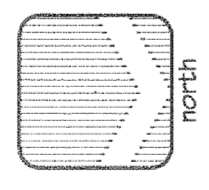

Electrical Fixture Schedule			
TYPE	LAMPS	DESCRIPTION	MODEL NUMBER
"A"	???	MATCH EXISTING FIXTURES	AS SELECTED BY OWNER
"B"			
"C"	???	RECESSED CAN LIGHTS	AS SELECTED BY OWNER
"X"	(2) 20W T6 1/2	EXIT LIGHT, UNIVERSAL MOUNTED, RED LETTERS & BATTERY BACK-UP	LITHONIA EZ - 2R SERIES
"EM"	(2) 6 VOLT PAR 36	WALL MOUNTED, SELF POWERED, EMERGENCY LIGHT FIXTURE W/ TWIN HEADS, SEALED BATTERY, PILOT LIGHT & TEST SWITCH	DUAL LITE EZ - 2R SERIES

TO DO LIST  
ADD FIXTURE SCHEDULE  
ADD ELECTRICAL SYMBOLS

 **Electrical Plan**  
Scale: 1/4" = 1'-0"  
0 2 4 6 8 10 12 feet

**BURMANN**  
Burmann Associates Inc.  
Architects • Engineers • Historic Restorations  
119 W. St. Clair • Romeo • Michigan • 48065  
greatarchitects@charter.net  
Cell 586-201-1602  
Member of the American Institute of Architects

Proposed Office Remodeling for:  
**Lapeer Township Offices**  
1500 Morris Road  
Lapeer, Michigan  
Location: Lapeer Twp, Michigan  
Michigan 2015 Building Code  
Consultant:

Revisions:

Sheet Contents:	
Electrical Plan	
Project Number:	20253
Drawn by:	REB
Date:	02OCT20
Sheet Number:	