

Proposed Interior Remodeling of Lapeer Township Offices

1500 Morris Rd. • Lapeer Township • Lapeer County • Michigan

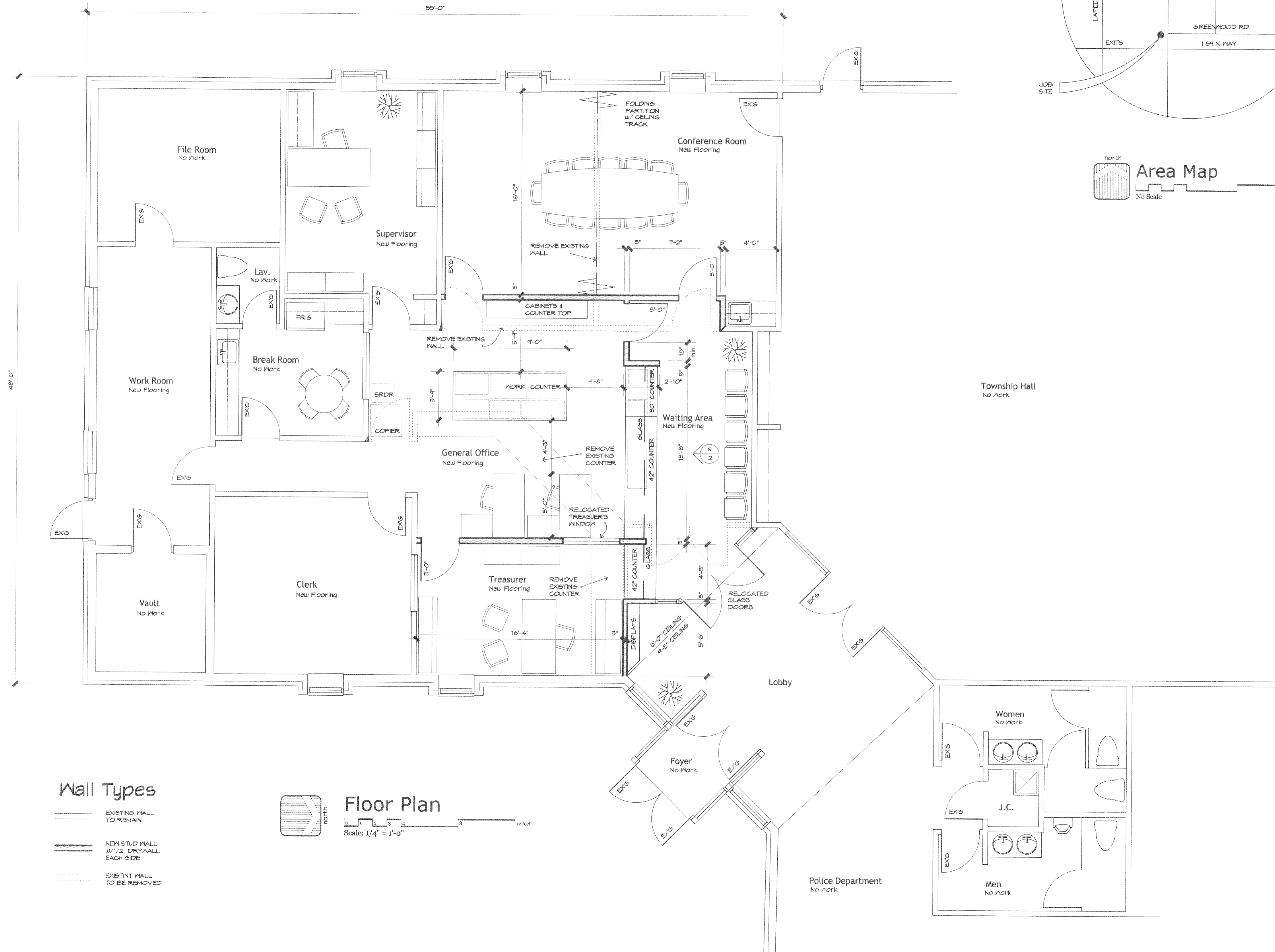

Sheet Index:

Floor Plan	1
Reflected Ceiling Plan	2
Details	3
Electrical Plan	4
Number of sheets in complete set:	4

Copyright © 2020

Applicable Building Codes:

MICHIGAN BUILDING CODE 2015
 STATE OF MICHIGAN ELECTRICAL CODE 2017
 MICHIGAN MECHANICAL CODE 2015
 MICHIGAN PLUMBING CODE 2015
 ANSI A117 - 2009 ACCESSIBILITY CODE
 INTERNATIONAL FIRE CODE 2015
 MICHIGAN 2015 USE TYPE: B (BUSINESS)
 MICHIGAN 2015 CONSTRUCTION TYPE: 3-B

Fire Suppression:

THE OFFICE AREA IS NOT FIRE SUPPRESSED

Areas:

TOTAL OFFICE AREA 2,513 s/f
 NET AREA:

Occupancy Load:

PER TABLE 1004.1.1
 BUSINESS AREAS: 1 per 100 s/f
 2,513/100 = 25 OCCUPANTS

Plumbing:

ALL PLUMBING FIXTURES, WATER LINES, SEWER LINES ARE EXISTING. NO CHANGES ARE PROPOSED AS PART OF THIS PROJECT.

HVAC System:

THE FURNACE, A/C SYSTEM, THERMOSTATS, EXHAUST AIR SYSTEMS AND FLOOR DUCT SYSTEM ARE EXISTING. NO CHANGES ARE PROPOSED AS PART OF THIS PROJECT.

Office Flooring:

ALL NEW FLOORING SHALL BE LAMINATED WOOD FLOORING #V061600B04 COLOR 00604, NOMINAL SIZE 7X48", SNAP TOGETHER, MANUFACTURED BY LVT PLANKS.



Burmann Associates Inc.
 Architects • Engineers • Historic Restorations
 119 W. St. Clair • Romeo • Michigan • 48065
 greatarchitects@charter.net
 Call 586-201-1602
 Member of the American Institute of Architects

Proposed Office Remodeling for:

Lapeer Township Offices

1500 Morris Road
 Lapeer, Michigan

Location: Lapeer Twp, Michigan

Michigan 2015 Building Code

Consultant:

Revisions:

Sheet Contents:

Floor Plan

Project Number: 20253

Drawn by: REB

Date: 02OCT20

Sheet Number:

20253 Lapeer Twp. Offices printed on Mon 30-Nov-2020 at 10:58am by Burmann using O'Flaherty v.4.1. Drawings and architectural design copyright © 2020 Burmann Associates Architects. All rights reserved.